

**This electronic collection of documents is provided
for the convenience of the user
and is Not a Certified Document –**

**The documents contained herein were originally issued
and sealed by the individuals whose names and license
numbers appear on each page, on the dates appearing
with their signature on that page.**

**This file or an individual page
shall not be considered a certified document.**

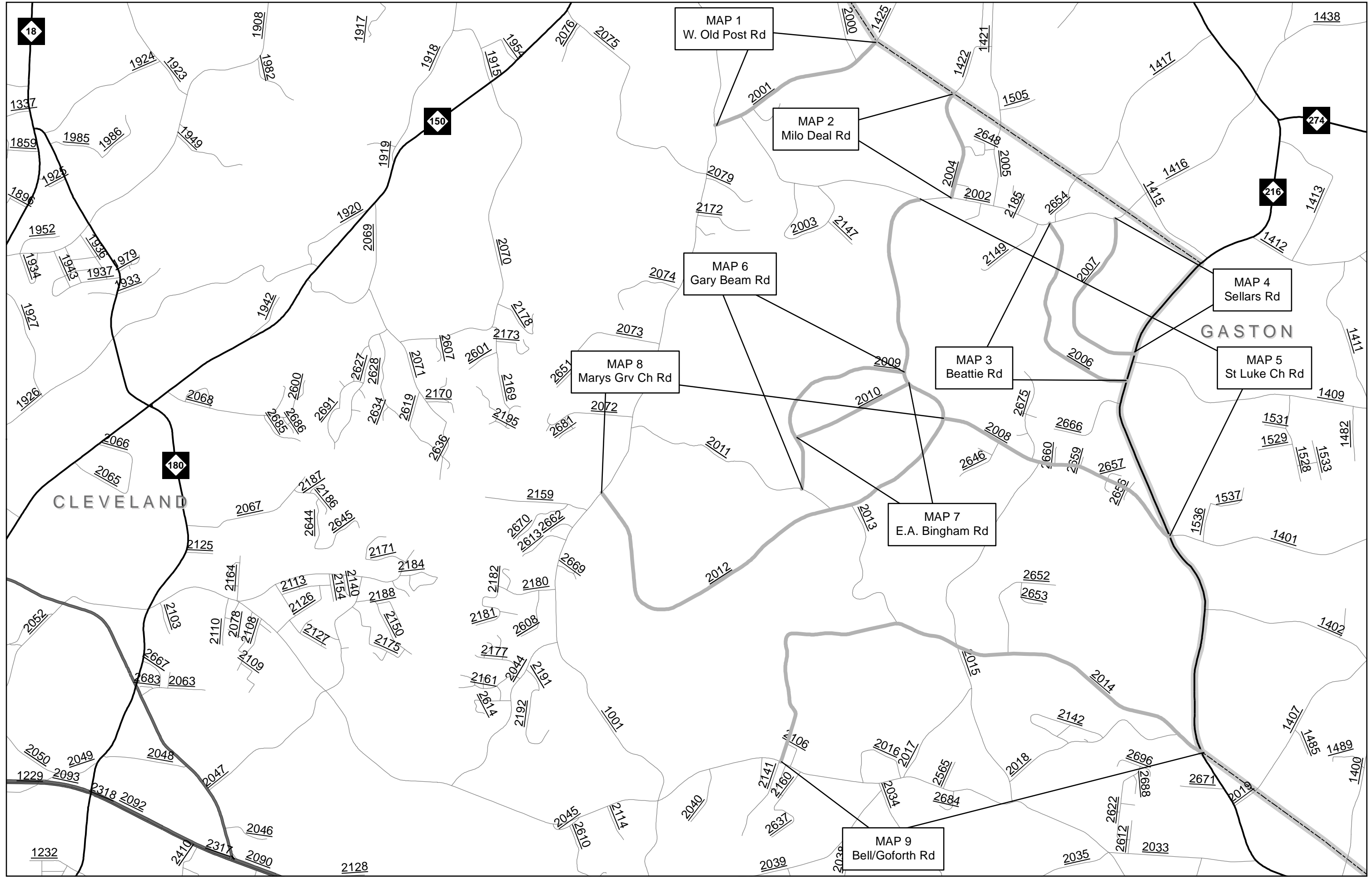

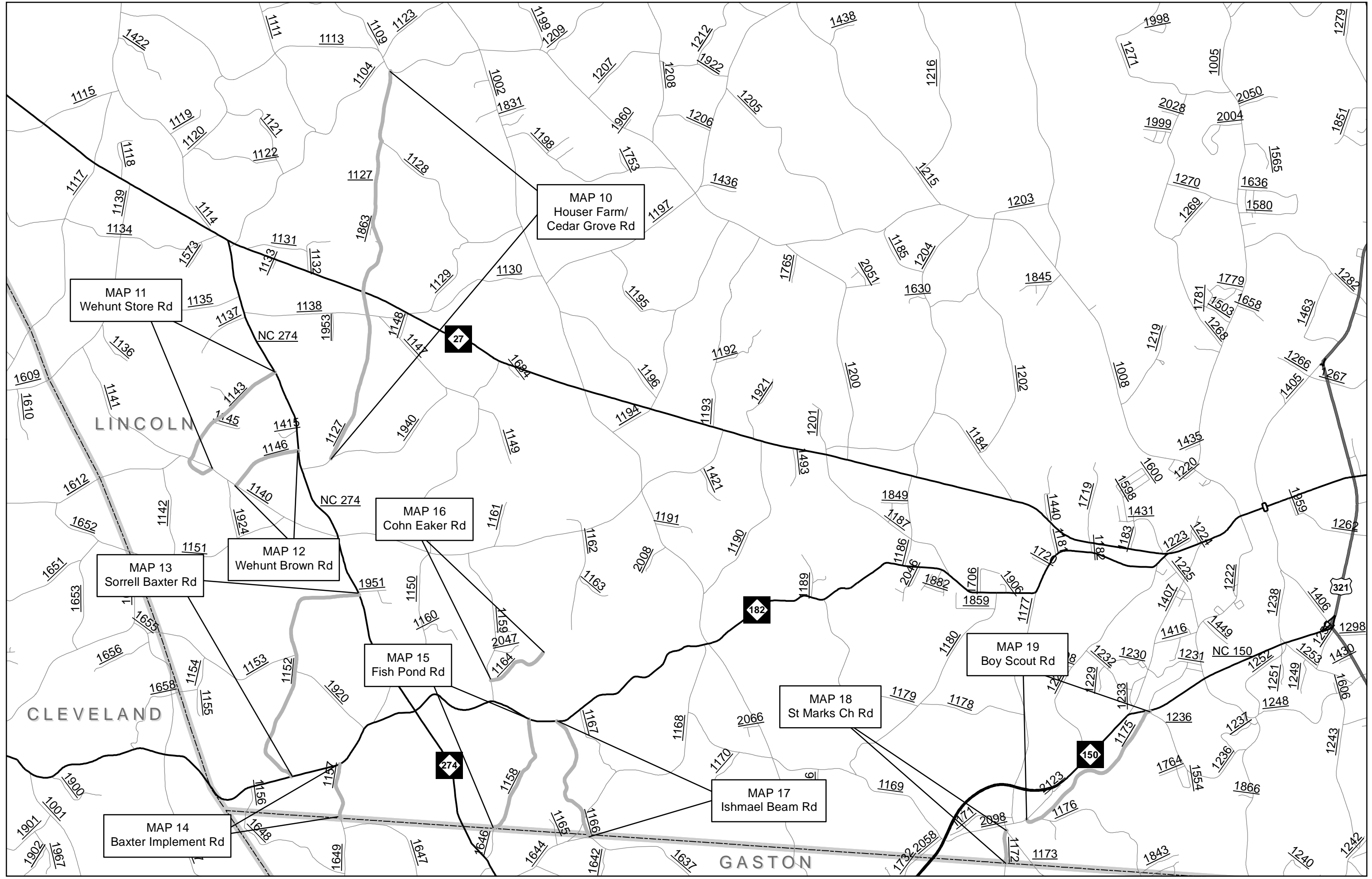

STATE	PROJECT WBS	SHEET NUMBER
NC	2023CPT.12.10.20232	4
	2023CPT.12.10.20552	

PAVEMENT SCHEDULE	
F	Latex Modified Microsurfacing Type III at an Application Rate of 22 to 26 Pounds per Square Yard

Checked by:

Drawn by: G. Brittain

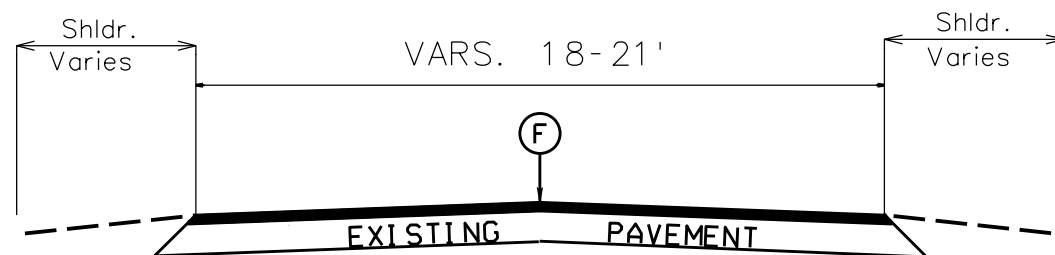

TYPICAL SECTION NO. 1
All Maps

2023-2024
Pavement Preservation
Cleveland and Lincoln
Counties

PROJECT NO.	SHEET NO.	TOTAL NO.
2023CPT.12.10.20232, 2023CPT.12.10.20552		

SUMMARY OF QUANTITIES

PROJECT NO	COUNTY	MAP NO	ROUTE	DESCRIPTION	TYP NO	LANES	LANE TYPE	FINAL SURFACE TESTING REQUIRED	WARM MIX ASPHALT REQUIRED	LENGTH		WIDTH		1891000000-E	2143000000-E
										MI	FT	LATEX MOD MICROSURFACE, TYPE III	BLOTTING SAND		
												SY	TON		
2023CPT.12.10.20232	Cleveland	1	SR 2001 (W. OLD POST RD)	FROM SR 1001 TO GASTON CL	1	2	2WU	NO	NO	1.35	19	15,800	5		
2023CPT.12.10.20232	Cleveland	2	SR 2004 (MILO DEAL RD)	FROM SR 2002 TO GASTON CL	1	2	2WU	NO	NO	0.8	19	9,363			
2023CPT.12.10.20232	Cleveland	3	SR 2006 (BEATTIE RD)	FROM SR 2002 TO NC 216	1	2	2WU	NO	NO	1.58	20	19,466			
2023CPT.12.10.20232	Cleveland	4	SR 2007 (SELLARS RD)	FROM SR 2002 TO NC 216	1	2	2WU	NO	NO	1.38	21	17,852			
2023CPT.12.10.20232	Cleveland	5	SR 2008 (ST. LUKE CHURCH RD)	FROM NC 216 TO SR 2002	1	2	2WU	NO	NO	3.77	21	48,769			
2023CPT.12.10.20232	Cleveland	6	SR 2009 (GARY BEAM RD)	FROM SR 2008 TO SR 2011	1	2	2WU	NO	NO	1.53	19	17,907			
2023CPT.12.10.20232	Cleveland	7	SR 2010 (E.A. BINGHAM RD)	FROM SR 2009 TO SR 2008	1	2	2WU	NO	NO	0.9	20	11,088			
2023CPT.12.10.20232	Cleveland	8	SR 2012 (MARYS GROVE CHURCH RD)	FROM SR 1001 TO SR 2008	1	2	2WU	NO	NO	3.56	20	43,859			
2023CPT.12.10.20232	Cleveland	9	SR 2014 (BELL/GOFORTH RD)	FROM SR 2033 TO NC 216	1	2	2WU	NO	NO	4.22	19	49,391			
TOTAL FOR PROJ NO. 2023CPT.12.10.20232										19.09		233,495	5		
2023CPT.12.10.20552	Lincoln	10	SR 1127 (HOUSER FARM/CEDAR GROVE CH RD)	FROM SR 1940 TO SR 1128	1	2	2WU	NO	NO	3.62	20	44,598	5		
2023CPT.12.10.20552	Lincoln	11	SR 1143 (WEHUNT STORE RD)	FROM NC 274 TO SR 1140	1	2	2WU	NO	NO	1.69	18	18,739			
2023CPT.12.10.20552	Lincoln	12	SR 1146 (WEHUNT BROWN RD)	FROM NC 274 TO SR 1140	1	2	2WU	NO	NO	0.82	18	9,092			
2023CPT.12.10.20552	Lincoln	13	SR 1152 (SORRELL BAXTER RD)	FROM NC 274 TO NC 182	1	2	2WU	NO	NO	2.79	20	34,373			
2023CPT.12.10.20552	Lincoln	14	SR 1157 (BAXTER IMPLEMENT RD)	FROM NC 182 TO GASTON CL	1	2	2WU	NO	NO	0.62	18	6,875			
2023CPT.12.10.20552	Lincoln	15	SR 1158 (FISH POND RD)	FROM NC 182 TO GASTON CL	1	2	2WU	NO	NO	1.35	20	16,632			
2023CPT.12.10.20552	Lincoln	16	SR 1164 (COHN EAKER RD)	FROM SR 1159 TO DEAD END	1	2	2WU	NO	NO	0.72	20	8,870			
2023CPT.12.10.20552	Lincoln	17	SR 1166 (ISHMAEL BEAM RD)	FROM NC 182 TO TOT DELINGER RD	1	2	2WU	NO	NO	1.45	20	17,864			
2023CPT.12.10.20552	Lincoln	18	SR 1172 (ST. MARKS CH. RD)	FROM SR 1173 TO GASTON CL	1	2	2WU	NO	NO	0.43	18	4,768			
2023CPT.12.10.20552	Lincoln	19	SR 1175 (BOY SCOUT RD)	FROM SR 2098 TO SR 1236	1	2	2WU	NO	NO	1.95	21	25,225			
TOTAL FOR PROJ NO. 2023CPT.12.10.20552										15.44		187,036	5		
GRAND TOTAL										34.53		420,531	10		

PROJECT NO.	SHEET NO.	TOTAL NO.
2023CPT.12.10.20232,		
2023CPT.12.10.20552		

THERMOPLASTIC AND PAINT QUANTITIES

PROJECT NO	COUNTY	MAP NO	ROUTE	DESCRIPTION	TYP NO	LANES	LANE TYPE	LENGTH	WIDTH	4413000000-E	4457000000-N	4704000000-E	4709000000-E	4720000000-E	4810000000-E		4891000000-E	4870000000-E	4875000000-N
										WORK ZONE ADV/GEN WARNING SIGNS	TEMP TRAFFIC CONTROL	16" X 90 M WHITE THERMO	24" X 90 M WHITE THERMO	THERMO MSG RXR 90 M	4" WHITE PAINT	4" YELLOW PAINT	REMOVAL OF PAVEMENT MKG. LINES 16"	REMOVAL OF PAVEMENT MKG. LINES 24"	REMOVAL OF PAVEMENT MKG. SYMBOLS & CHARACTERS
										SF	LS	LF	LF	EA	LF	LF	LF	LF	EA
2023CPT.12.10.20232	Cleveland	1	SR 2001 (W. OLD POST RD)	FROM SR 1001 TO GASTON CL	1	2	2WU	1.35	19	84	*				29,052	29,052			
2023CPT.12.10.20232	Cleveland	2	SR 2004 (MILO DEAL RD)	FROM SR 2002 TO GASTON CL	1	2	2WU	0.8	19	84					17,216	17,216			
2023CPT.12.10.20232	Cleveland	3	SR 2006 (BEATTIE RD)	FROM SR 2002 TO NC 216	1	2	2WU	1.58	20	116					34,002	20,856			
2023CPT.12.10.20232	Cleveland	4	SR 2007 (SELLARS RD)	FROM SR 2002 TO NC 216	1	2	2WU	1.38	21	116					29,146	29,146			
2023CPT.12.10.20232	Cleveland	5	SR 2008 (ST. LUKE CHURCH RD)	FROM NC 216 TO SR 2002	1	2	2WU	3.77	21	180					79,623	79,623			
2023CPT.12.10.20232	Cleveland	6	SR 2009 (GARY BEAM RD)	FROM SR 2008 TO SR 2011	1	2	2WU	1.53	19	116					32,314	32,314			
2023CPT.12.10.20232	Cleveland	7	SR 2010 (E.A. BINGHAM RD)	FROM SR 2009 TO SR 2008	1	2	2WU	0.9	20	84					19,008	19,008			
2023CPT.12.10.20232	Cleveland	8	SR 2012 (MARYS GROVE CHURCH RD)	FROM SR 1001 TO SR 2008	1	2	2WU	3.56	20	180					75,188	75,188			
2023CPT.12.10.20232	Cleveland	9	SR 2014 (BELL/GOFORTH RD)	FROM SR 2033 TO NC 216	1	2	2WU	4.22	19	260					90,814	55,704			
TOTAL FOR PROJ NO. 2023CPT.12.10.20232								19.09		1,220				406,363	358,107				
										1,220				764,470					
2023CPT.12.10.20552	Lincoln	10	SR 1127 (HOUSER FARM/CEDAR GROVE CH RD)	FROM SR 1940 TO SR 1128	1	2	2WU	3.62	20	324	*				77,902	67,784			
2023CPT.12.10.20552	Lincoln	11	SR 1143 (WEHUNT STORE RD)	FROM NC 274 TO SR 1140	1	2	2WU	1.69	18	116					36,369	36,369			
2023CPT.12.10.20552	Lincoln	12	SR 1146 (WEHUNT BROWN RD)	FROM NC 274 TO SR 1140	1	2	2WU	0.82	18	84					17,646	17,646			
2023CPT.12.10.20552	Lincoln	13	SR 1152 (SORRELL BAXTER RD)	FROM NC 274 TO NC 182	1	2	2WU	2.79	20	148					60,041	60,041			
2023CPT.12.10.20552	Lincoln	14	SR 1157 (BAXTER IMPLEMENT RD)	FROM NC 182 TO GASTON CL	1	2	2WU	0.62	18	84					13,342	13,342			
2023CPT.12.10.20552	Lincoln	15	SR 1158 (FISH POND RD)	FROM NC 182 TO GASTON CL	1	2	2WU	1.35	20	116					29,052	29,052			
2023CPT.12.10.20552	Lincoln	16	SR 1164 (COHN EAKER RD)	FROM SR 1159 TO DEAD END	1	2	2WU	0.72	20	84					15,494	15,494			
2023CPT.12.10.20552	Lincoln	17	SR 1166 (ISHMAEL BEAM RD)	FROM NC 182 TO TOT DELINGER RD	1	2	2WU	1.45	20	116					31,204	31,204			
2023CPT.12.10.20552	Lincoln	18	SR 1172 (ST. MARKS CH. RD)	FROM SR 1173 TO GASTON CL	1	2	2WU	0.43	18	84					9,254	9,254			
2023CPT.12.10.20552	Lincoln	19	SR 1175 (BOY SCOUT RD)	FROM SR 2098 TO SR 1236	1	2	2WU	1.95	21	164		100	70	4	41,964	35,740	100	70	4
TOTAL FOR PROJ NO. 2023CPT.12.10.20552								15.44		1,320		100	70	4	332,268	315,926	100	70	4
										1,320				648,194					
GRAND TOTAL								34.53		2,540	1	100	70	4	738,631	674,033	100	70	4
										2,540				1,412,664					

SIGNING FOR ASPHALT SURFACE TREATMENT

LEGEND

- ▷ PORTABLE SIGN
- └ STATIONARY SIGN
- ← DIRECTION OF TRAFFIC FLOW

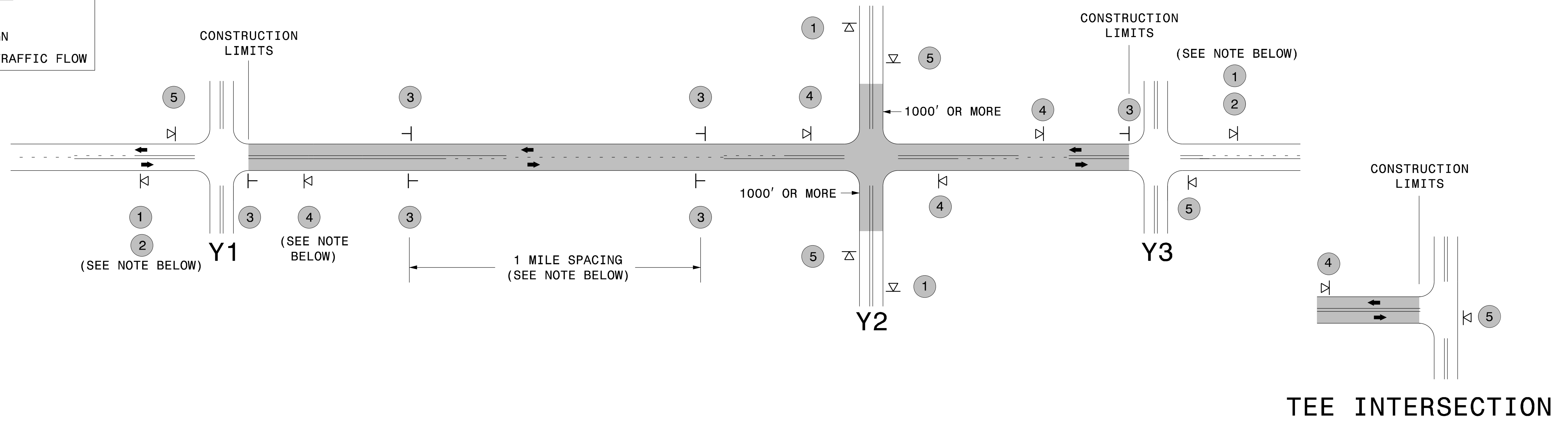

MAINLINE (-L-) SIGNING

-Y- LINE SIGNING

SIGNING NOTES AND PLACEMENT PER DIRECTION	1	 W20-1 48" X 48"	- PLACE 1000' PRIOR TO BEGINNING OF CONSTRUCTION LIMITS. ONLY USED ON -Y- LINES IF RESURFACING LIMITS EXTEND 1000' ALONG -Y- LINE.	<p>STATIONARY SIGNING NOT REQUIRED FOR THE FOLLOWING -Y- LINE CONDITIONS:</p> <ol style="list-style-type: none"> 1) LESS THAN 1000' OF RESURFACING ALONG -Y- LINE 2) SUBDIVISION ROADS 3) DEAD END ROADS <p>WHEN PAVING/CONSTRUCTION ACTIVITIES PROCEED ACROSS AN UNSIGNED -Y- LINE, PORTABLE ADVANCE WARNING SIGNS SHALL BE USED ALONG THE -Y- LINE AS SHOWN BELOW. REMOVE UPON COMPLETION OF WORK.</p> <div style="display: flex; justify-content: space-around;"> <div style="text-align: center;"> W20-1 48" X 48" PLACED 500' IN ADVANCE OF FLAGGER. </div> <div style="text-align: center;"> W20-7 A 48" X 48" PLACED 250' IN ADVANCE OF FLAGGER. </div> </div>
	2	 W7-3qP 24" X 18"	- SIGN #2 ONLY USED WHEN RESURFACING LIMITS ARE 2 OR MORE MILES IN LENGTH. ROUND UP TO THE NEAREST WHOLE NUMBER. DO NOT USE FRACTIONAL OR DECIMAL NUMBERS.	
	3	 W8-7 48" X 48"	- ALTERNATE THE FOLLOWING TWO SIGNS: - STARTING WITH "LOOSE GRAVEL" (W8-7) FOLLOWED BY "UNMARKED PAVEMENT". - PLACE INITIALLY AT THE CONSTRUCTION LIMITS AND SPACED 1 MILE APART THEREAFTER.	
		 SP 48" X 48"	- AT TEE INTERSECTIONS INSTALL INITIALLY 0.5 MILE FROM INTERSECTION AND SPACE 1 MILE APART THEREAFTER.	
	4	 SP 13106 48" X 48"	- THESE ARE FOR -Y- LINES THAT ARE "THROUGH" ROADWAYS. DEAD END AND SUBDIVISION ROADS ARE NOT "THROUGH" ROADWAYS. - INSTALL 500' +/- FROM EACH -Y- LINE APPROACH AS SHOWN ABOVE. - FOR MULTIPLE -Y- LINES THAT ARE SEPARATED BY 0.25 MILES OR LESS, TREAT AS A SINGLE UNIT AND INSTALL WITHIN 500' OF EACH APPROACH. - A MAXIMUM OF 2 SIGN SETS PER MILE. DO NOT INSTALL WHEN -Y- LINES ARE WITHIN 0.5 MILES FROM "END ROAD WORK" SIGN.	
5	 G20-2 A 48" X 24"	PLACE 500' FOLLOWING THE END OF CONSTRUCTION LIMITS OR AS SHOWN WHEN WORK ENDS AT A 3-WAY TEE INTERSECTION.		

THE ABOVE SIGNS ARE ALL THAT ARE REQUIRED FOR A CONTRACTOR TO BEGIN A RESURFACING CONTRACT. ANY ADDITIONAL SIGNS REQUESTED BY NCDOT DIVISIONS SHALL BE INSTALLED WITHIN 7 BUSINESS DAYS OF THE START OF CONTRACT WORK.

MAPS LESS THAN 2 MILES

FOR AST RESURFACING MAPS WITH CONSTRUCTION LIMITS LESS THAN 2 MILES IN LENGTH, USE A STATIONARY "LOOSE GRAVEL" SIGN AT THE BEGINNING CONSTRUCTION LIMIT FOLLOWED BY AN "UNMARKED PAVEMENT" SIGN MIDWAY THROUGH AND AN "END ROAD WORK" SIGN AT THE END CONSTRUCTION LIMIT.

ADVANCE WARNING SIGNS FOR 2-LANE ROADWAY ASPHALT SURFACE TREATMENT